

Pressure Reducing Valve

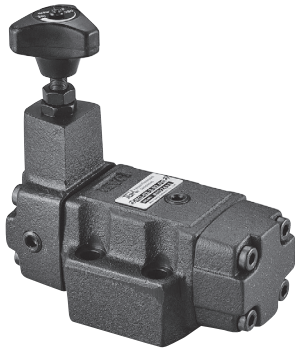

閥類型符號 SYMBOL

R※- ※

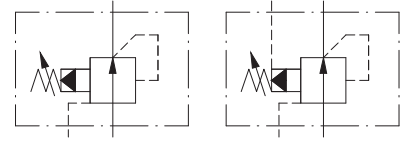

規格說明

SPECIFICATION

型式 MODEL		最高使用壓力 MAX. OPERATING PRESSURE kgf/cm ²	調壓範圍 PRESSURE ADJ. RANGE kgf/cm ²	最大流量 MAX. FLOW L/min	重量 WEIGHT kg	
板式安裝 SUB-PLATE MOUNTING	管式安裝 THREADED CONNECTIONS					
RG-03	RT-03	250	0 : 7-35 1 : 7-70 2 : 7-140 3 : 7-210	50	4.9	4.4
RG-06	RT-06				7.2	7.5
RG-10	RT-10			250	12.2	12.2

型號說明

HOW TO ORDER

RG-06-3-30-TU

附屬品

ATTACHMENT

型式 MODEL	安裝螺絲 SOC HOL CAP SCREW	安裝扭矩 MOUNTING TORQUE N·m
RG-03	M10 x 55L...4pcs	60~74
RG-06	M10 x 55L...4pcs	
RG-10	M10 x 55L...6pcs	

螺牙固定RT-03唯一型式 ONLY FOR RT-03 TYPE

調桿型式 ADJUSTMENT TYPE
30 : 標準型 STANDARD TYPE
32 : T型推環直結式 THRUST RING LINK TYPE

調壓範圍 PRESSURE ADJUSTING RANGE
0 : 7-35 kgf/cm² 1 : 7-70 kgf/cm²
2 : 7-140 kgf/cm² 3 : 7-210 kgf/cm²

閥規格 VALVE SIZE
03 : 3/8" 06 : 3/4" 10 : 1-1/4"

安裝型式 MOUNTING
G : 板式安裝 SUB-PLATE MOUNTING
T : 管式安裝 THREADED CONNECTIONS

系列編號 SERIES NUMBER

測試條件

PERFORMANCE CURVES

測試油黏度 TEST FLUID VISCOSITY : 35cSt

測試油溫度 TEST TEMPERATURE : 50°C

● RG, RT-03

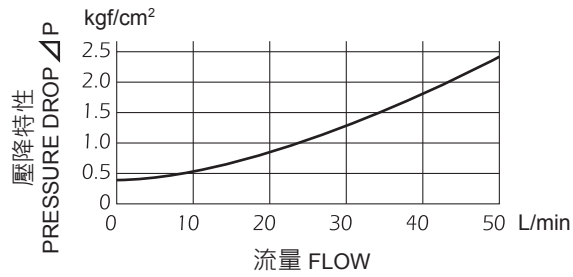

● RG, RT-06

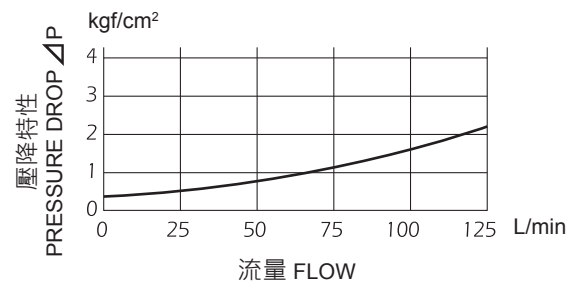

● RG, RT-10

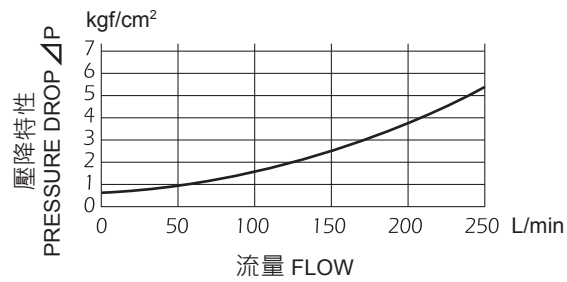

單位 UNIT : mm

安裝尺寸 INSTALLATION DIMENSIONS

RG-03~10

通用底板尺寸
 APPLICATIVE
 SUB-PLATE DIMENSIONS
RG-03 (MA - 06 - 1)
RG-06 (MA - 06 - 2)
RG-10 (MA - 06 - 3)
 (詳見 E01-05 Page E01-05)

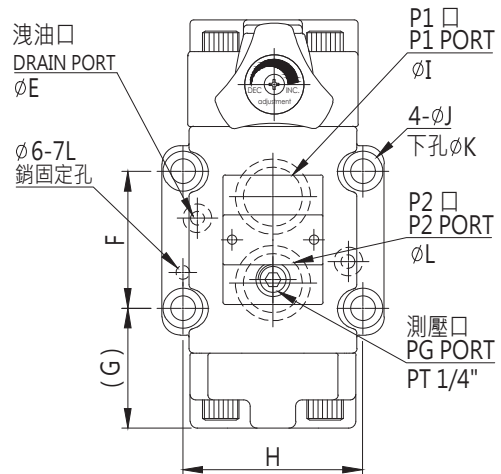
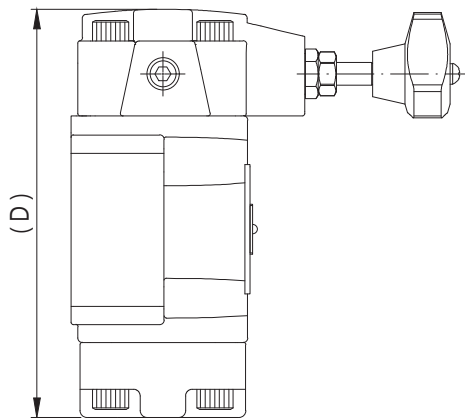
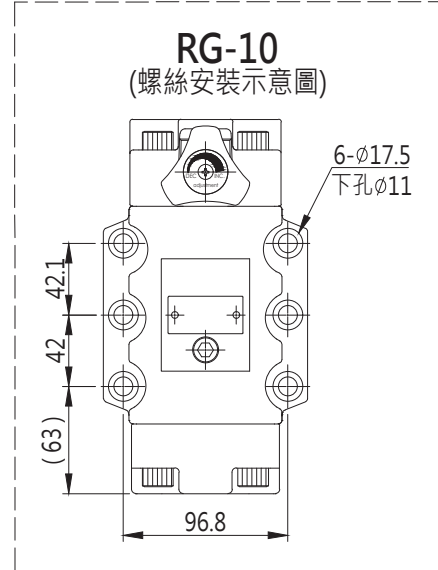
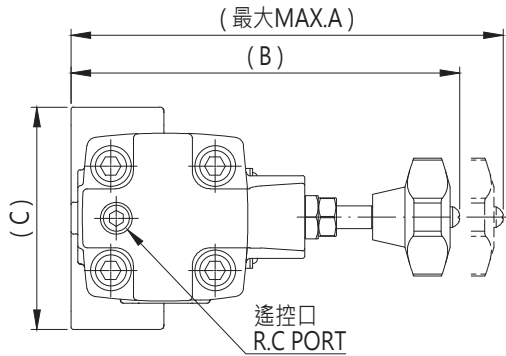

型式 MODEL	A	B	C	D	E	F
RG-03	173.5	157.5	90	161.5	4	42.8
RG-06	172	156	98	180	5	60.3
RG-10	173.5	157.5	120	220	5	

型式 MODEL	G	H	I	J	K	L
RG-03	52.1	66.7	15	17.5	11	15
RG-06	52.9	79.4	25	17.5	11	25
RG-10			30			30

單位 UNIT : mm

安裝尺寸 INSTALLATION DIMENSIONS

RT-03~10

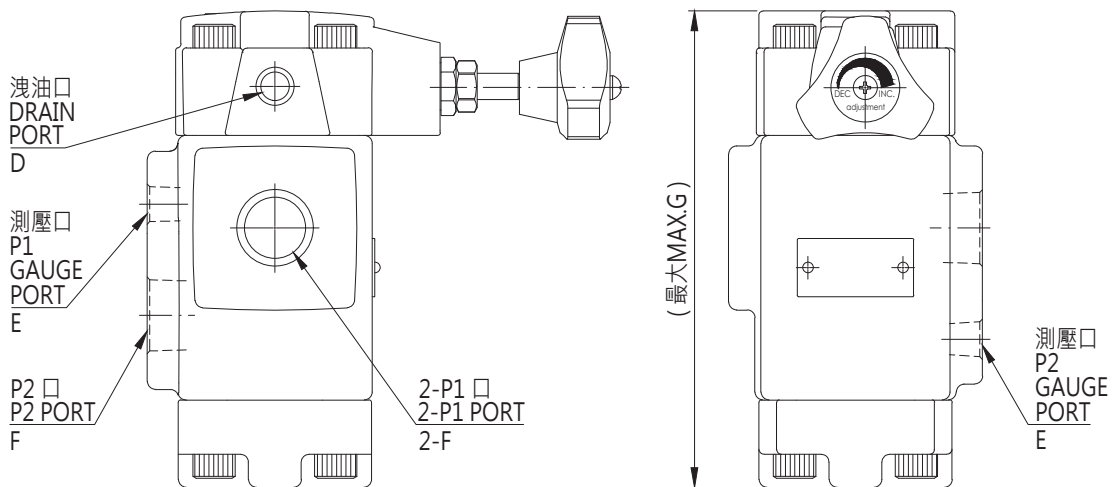
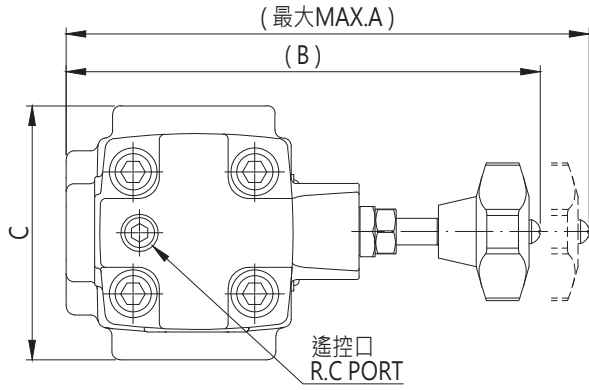

型式 MODEL	A	B	C	D	E	F	G
RT-03	177.5	161.5	82	PT 1/4"	PT 1/4"	PT 3/8"	161.5
RT-06	180	164	96	PT 1/4"	PT 1/4"	PT 3/4"	180
RT-10	189.5	173.5	132	PT 1/4"	PT 1/4"	PT 1-1/4"	220